

BTF800 PARTS LIST

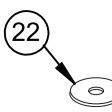

Suitable for loads
up to 30kg

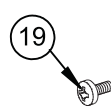
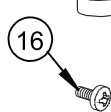
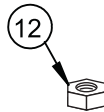
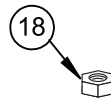
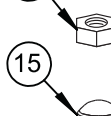
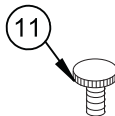
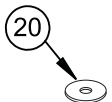
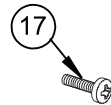
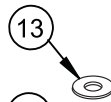
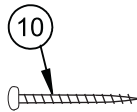
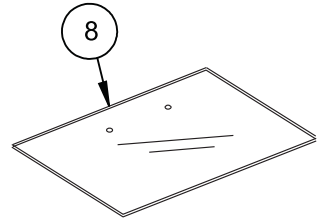
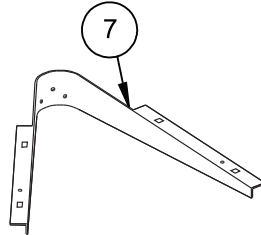
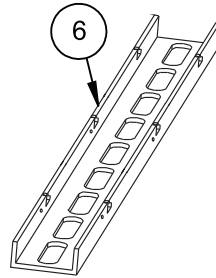
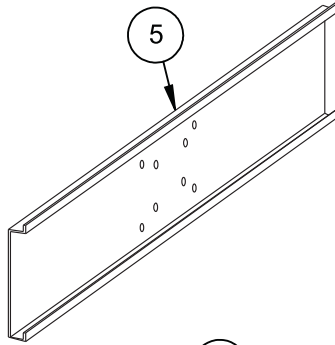
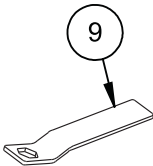
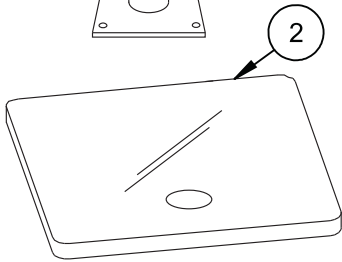
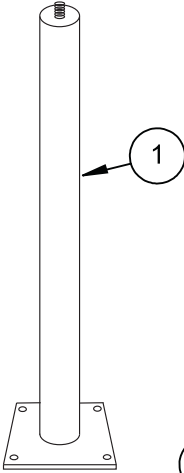
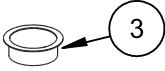
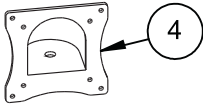
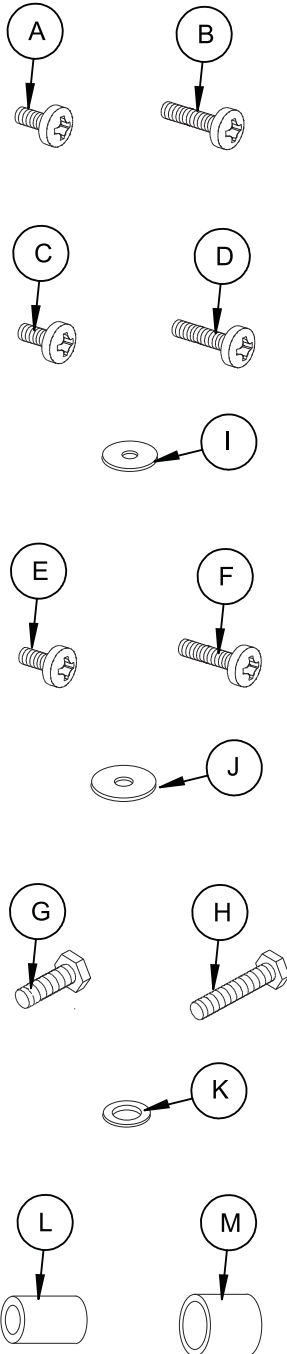

Item	Part Name	Qty
1	SUPPORT COLUMN	1
2	BASE COVER	1
3	POLE RING	1
4	MOUNTING HEAD	1
5	MOUNTING PLATE	1
6	INTERFACE ARM	2
7	SHELF MOUNT	1
8	GLASS SHELF	1
9	SPANNER	1
10	M5 x 25mm SCREW	8
11	SHELF SCREW	2
12	NUT	2
13	M10 WASHER	1
14	M10 NUT	1
15	M10 NUT CAP	1
16	M5 x 10mm SCREW	5
17	M5 x 15mm SCREW	4
18	M5 NUT	4
19	M5 x 6mm SCREW	2
20	M5 WASHER	4
21	M5 NUT CAP	4
22	M6 WASHER	2
Item	Interface Kit	Qty
A	M4 x 12mm SCREW	4
B	M4 x 35mm SCREW	4
C	M5 x 15mm SCREW	4
D	M5 x 35mm SCREW	4
E	M6 x 15mm SCREW	4
F	M6 x 35mm SCREW	4
G	M8 x 15mm SCREW	4
H	M8 x 30mm SCREW	4
I	M5 WASHER	4
J	M6 WASHER	4
K	M8 WASHER	12
L	M5 M6 SPACER	4
M	M8 SPACER	4

PLEASE KEEP THIS FOR FUTURE REFERENCE

INSTALLATION INSTRUCTIONS

1

i. Slide base cover (part 2) over the support column (part 1).

ii. Use pole ring (part 3) to fix base cover in place.

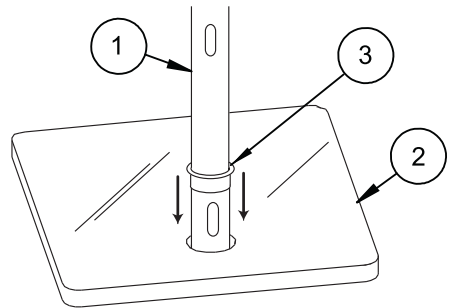
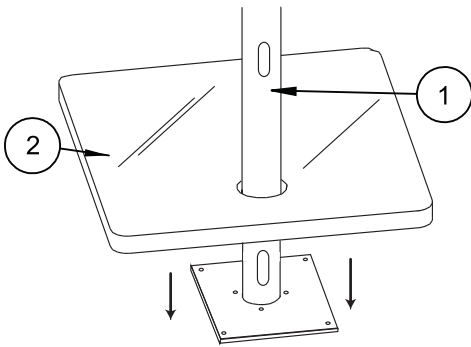

2

Secure support column to to base cover by using the provided M5 x 25mm screws (part 10).

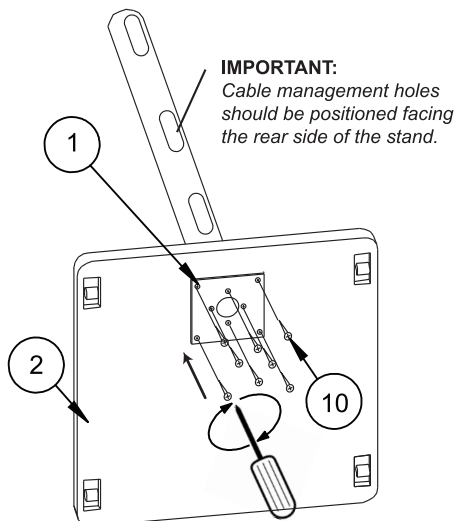

5

Attach interface arms (part 6) to screen using the supplied interface kit.
(Ensure the hooks on the arms are facing downwards).

Use 13mm spanner
for M8 screws

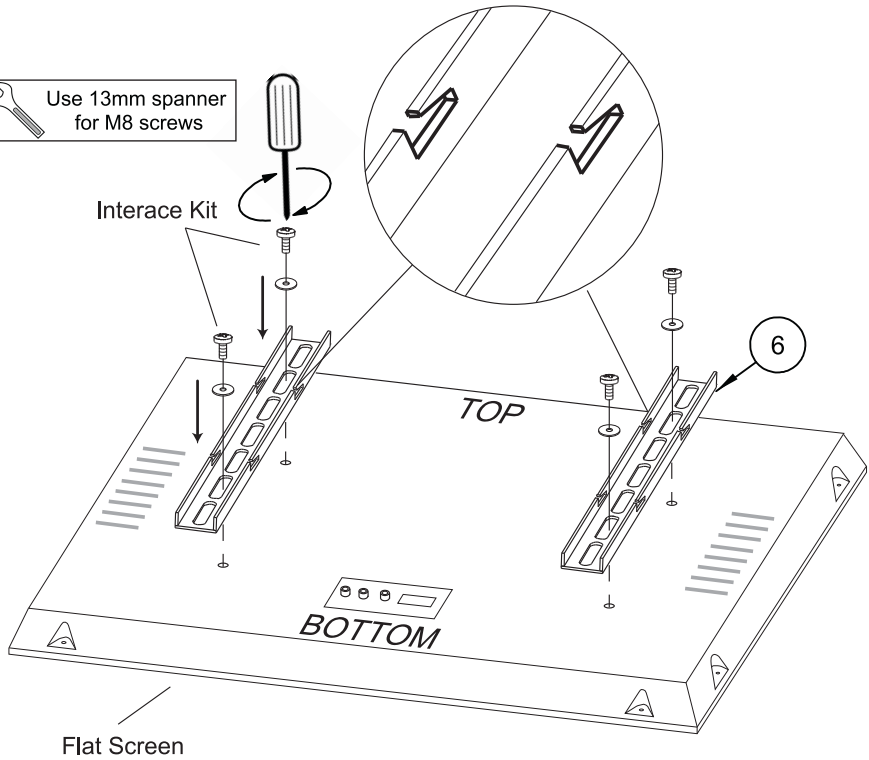

**FOR SCREENS WITH
RECESSED FIXINGS**

Use spacers (parts L and M)
on recess in flat screen and
for extra space for cables.

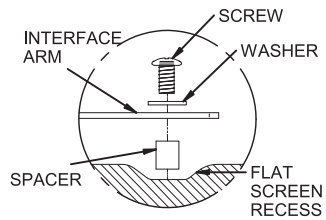
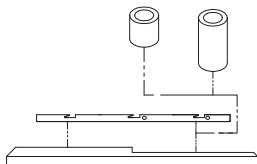

Please refer to screen
manufacturer manual for
guidance on screen mounting